

ETAM1 R03_EN

ETAM1 XETK/FETK ECU Adapter, SAMTEC FFSD - SAMTEC SFM
(10fc - 10fc), 0m11

Copyright

The data in this document may not be altered or amended without special notification from ETAS GmbH. ETAS GmbH undertakes no further obligation in relation to this document. The software described in it can only be used if the customer is in possession of a general license agreement or single license. Using and copying is only allowed in concurrence with the specifications stipulated in the contract.

Under no circumstances may any part of this document be copied, reproduced, transmitted, stored in a retrieval system or translated into another language without the express written permission of ETAS GmbH.

© Copyright 2015 ETAS GmbH, Stuttgart

The names and designations used in this document are trademarks or brands belonging to the respective owners.

Document ETAM1 R03_EN – 02.2015

Contents

- 1 Introduction.....5
 - 1.1 View.....5
- 2 Technical Data6
 - 2.1 ECU Connector.....6
 - 2.2 Measurement Drawings7
 - 2.3 Temperature Range7
- 3 ETAS Contact Addresses9

Figures

Figure 1: View 5

Figure 2: Pin Count 6

Figure 4: Top View 7

Figure 5: Side View 7

1 Introduction

ETAM1 adapts ECU a 10 pin SAMTEC TFM-105 connector to an FETK and XETK.

1.1 View

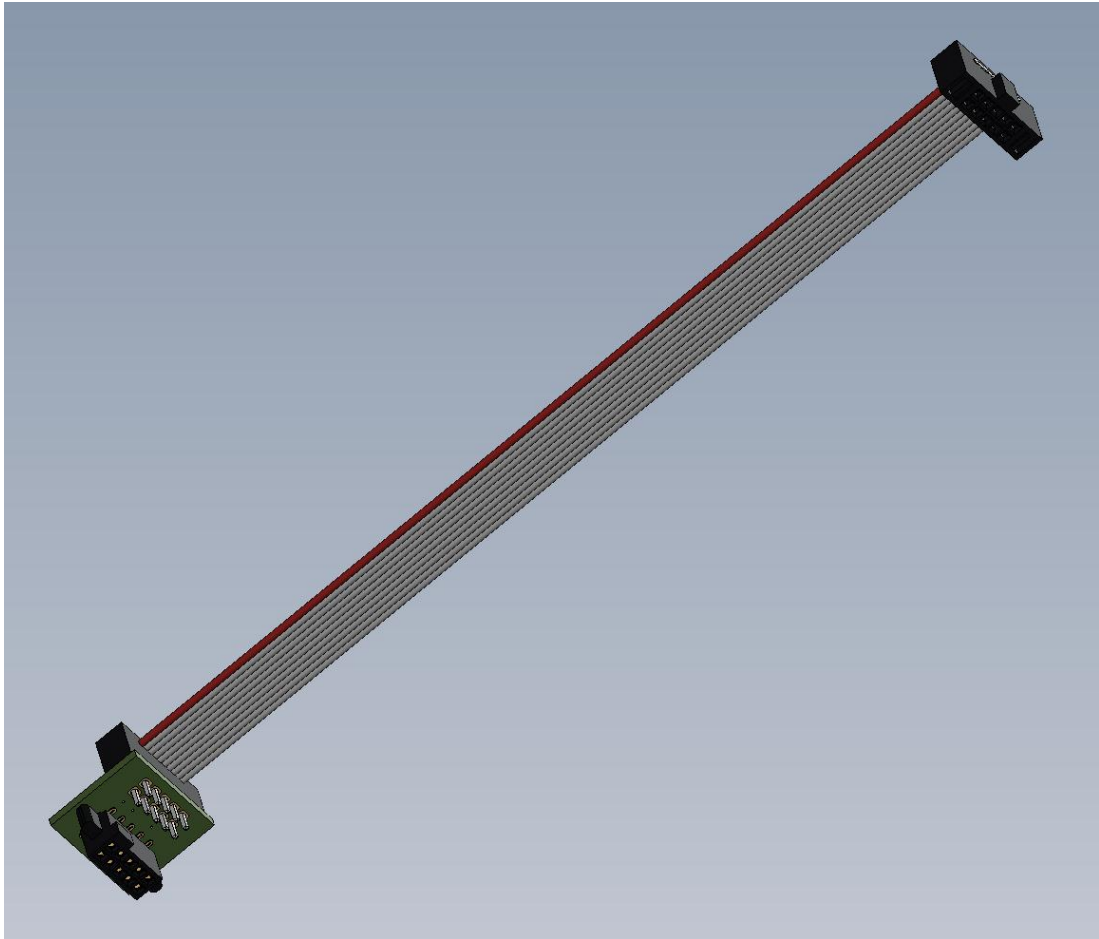

Figure 1: View

2 Technical Data

2.1 ECU Connector

In order to be able to use the ETK adapter ETAM1 in the ECU, a 10 pin SAMTEC connector (e.g. TFM-105-02-S-D-P) must be available on the ECU. JTAG or DAP mode depends on the used FETK or XETK.

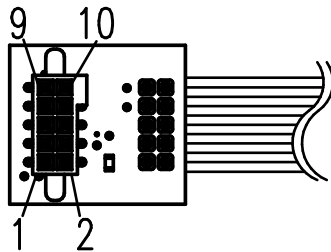

Figure 2: Pin Count

Pin Number	JTAG Mode	LFAST Mode	DAP Mode
1	GND	GND	GND
2	TCK	DRCLK	DAP0
3	/TRST	RXD-	/TRST
4	TDO	RXD+	DAP2
5	TMS	TXD+	DAP1
6	TDI	TXD-	-
7	WDGDIS	WDGDIS	WDGDIS
8	VDD (Sense)	VDD (Sense)	VDD (Sense)
9	/RESETOUT	/RESETOUT	/RESETOUT
10	/PORESET	/PORESET	/PORESET

2.2 Measurement Drawings

Measured in mm

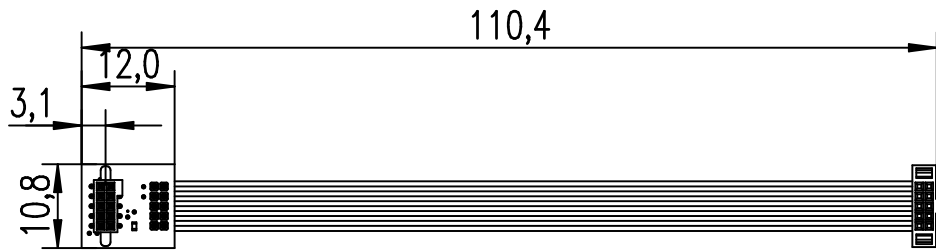

Figure 3: Bottom View

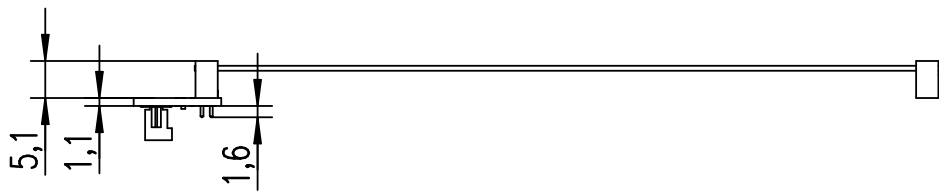

Figure 4: Side View

2.3 Temperature Range

Condition	Temperature
Operating Temperature	-40°C - +110°C

3 **Ordering Information**

Short Name	Order - Number
ETAM1	F 00K 109 305

4 ETAS Contact Addresses

ETAS HQ

ETAS GmbH

Borsigstraße 14

70469 Stuttgart

Germany

Phone: +49 711 3423-0

Fax: +49 711 3423-2300

WWW: www.etas.com*ETAS Subsidiaries and Technical Support*

For details of your local sales office as well as your local technical support team and product hotlines, take a look at the ETAS website:

ETAS subsidiaries

WWW: www.etas.com/en/contact.php

ETAS technical support

WWW: www.etas.com/en/hotlines.php