

# ETAS ETAM4

ETK Trace ECU Adapter, SAMTEC SSH - SAMTEC  
STH (20fc - 20mc), 0m17

Data Sheet

## **Copyright**

---

The data in this document may not be altered or amended without special notification from ETAS GmbH. ETAS GmbH undertakes no further obligation in relation to this document. The software described in it can only be used if the customer is in possession of a general license agreement or single license. Using and copying is only allowed in concurrence with the specifications stipulated in the contract.

Under no circumstances may any part of this document be copied, reproduced, transmitted, stored in a retrieval system or translated into another language without the express written permission of ETAS GmbH.

© **Copyright 2022** ETAS GmbH, Stuttgart

The names and designations used in this document are trademarks or brands belonging to the respective owners.

Document ETAM4 R07 EN – 02.2022

## Contents

---

1	About this Document.....	4
1.1	Classification of Safety Messages .....	4
2	Introduction .....	4
2.1	View .....	4
3	Technical Data .....	5
3.1	ECU Connector .....	5
3.2	Mechanical Dimensions.....	6
3.3	Temperature Range.....	6
4	Ordering Information .....	6
5	ETAS Contact Addresses .....	6

# 1 About this Document

---

## 1.1 Classification of Safety Messages

---

The safety messages used here warn of dangers that can lead to personal injury or damage to property:



indicates a hazardous situation with a high risk of death or serious injury if not avoided.



indicates a hazardous situation of medium risk, which could result in death or serious injury if not avoided.



indicates a hazardous situation of low risk, which may result in minor or moderate injury if not avoided.

### **NOTICE**

indicates a situation, which may result in damage to property if not avoided.

## 2 Introduction

---

ETAM4 adapts the ECU Micro-Controller Aurora Trace Signals to an FETK. It is a 1:1 adapter without active components. The ETAM4 covers only the trace specific signals. All other signals are covered by ETAM8 (or similar) and ETAM2 (or similar) adapter.

### 2.1 View

---

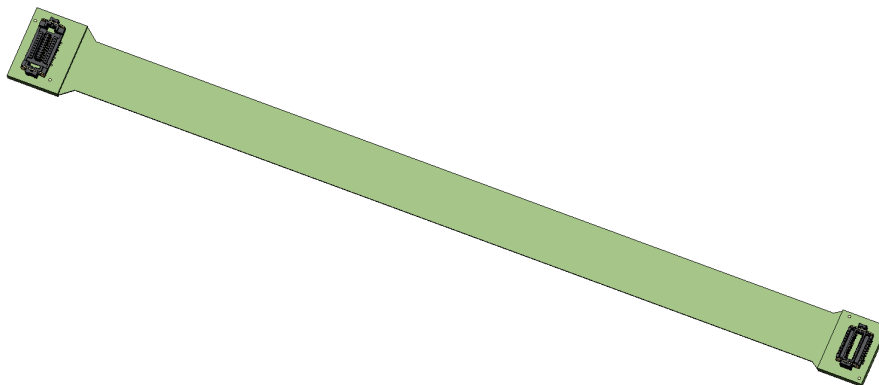

### 3 Technical Data

#### 3.1 ECU Connector

In order to be able to use the ETK adapter ETAM4 in the ECU, a 20 pin SAMTEC connector REF-196479-010 (like STH-010-0.50-G-D-K-TR) must be available on the ECU.

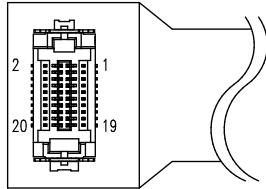

Pin Number	Trace Signal	Trace Signal	Pin Number
1	GND	GND	2
3	Data 1-	Data 0+	4
5	Data 1+	Data 0-	6
7	GND	GND	8
9	Data 2+	GND	10
11	Data 2-	CLK-	12
13	GND	CLK+	14
15	Data 3-	GND	16
17	Data 3+	Trace-Trigger	18
19	GND	CRC-Error	20



#### NOTE

Pin 18 Trig is not required for MC application but for the debugger in case of IFX trace. It is connected to a TrigIO pin of the  $\mu$ C. The necessary connection for Data [3..1] and CRC-Error depends on CPU-Vendor.

### 3.2 Mechanical Dimensions

Measured in mm.

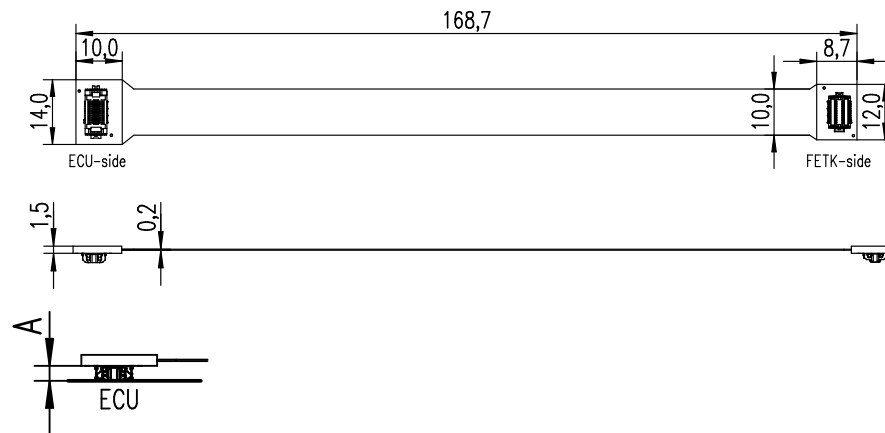

ECU Connector	Mated Height A in mm*
REF-196479-010 (STH-010-0.50-G-D-K-TR)	2.00
STH-010-1.00-G-D-K-TR	2.50

\* Processing conditions will affect mated height.

### 3.3 Temperature Range

Condition	Temperature
Operating Temperature	-40°C - +110°C

## 4 Ordering Information

Short Name	Order - Number
ETAM4	F 00K 109 979

## 5 ETAS Contact Addresses

### ETAS Headquarters

ETAS GmbH  
 Borsigstraße 24 Phone: +49 711 3423-0  
 70469 Stuttgart Fax: +49 711 3423-2106  
 Germany Internet: [www.etas.com](http://www.etas.com)

### ETAS Subsidiaries and Technical Support

For details of your local sales office as well as your local technical support team and product hotlines, take a look at the ETAS website:

ETAS subsidiaries Internet: [www.etas.com/en/contact.php](http://www.etas.com/en/contact.php)  
 ETAS technical support Internet: [www.etas.com/en/hotlines.php](http://www.etas.com/en/hotlines.php)