



Question:

Problem

To secure the C-source code of Simulink[®] S-Functions, it makes sense to give away only the generated Simulink DLL (new: mexw32 or mexw64) and the target specified object file.

Reason

LABCAR OPERATOR (more exactly : LABCAR-MCS) generates the necessary object files (.o-Files) out of the appropriate C-source code but stores the original source code files in the project folder too.



Answer:

Solution

1. Create a new Project, import your Simulink[®]-model and build it as usual. The LCO creates during the Build some .o-Files.
2. These files are found in the directory:

\\Target_RTPC\codegen\simodels\

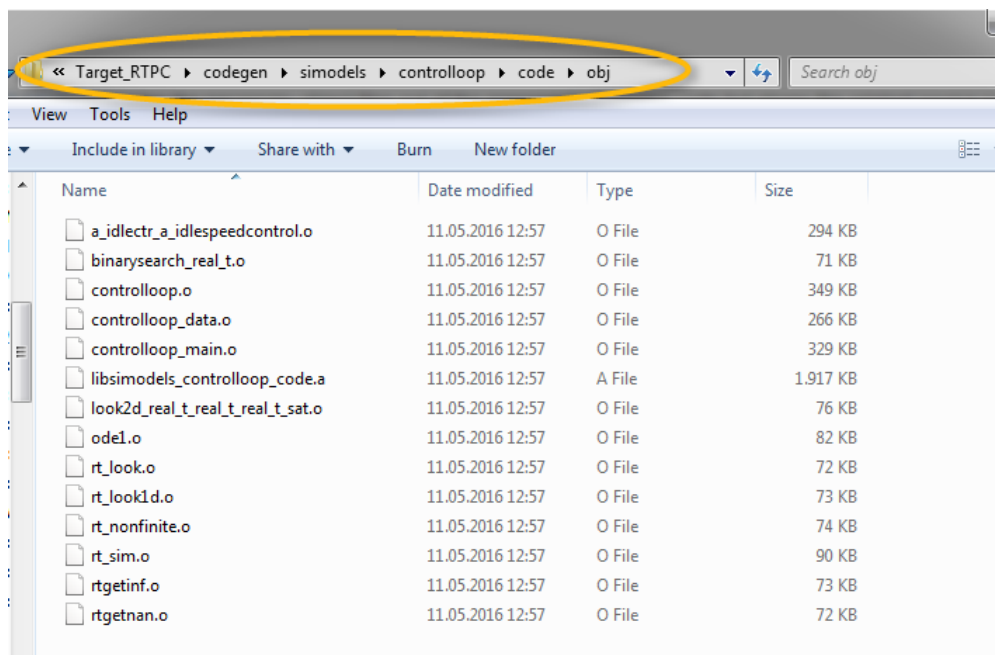

3. Now copy all the .o-Files of the S-Functions which you want to protect. They are simply named <S-Function name>.o

- Next change to the folder: \\Target_RTPC\SimulinkModels\Simulink_<modelName>

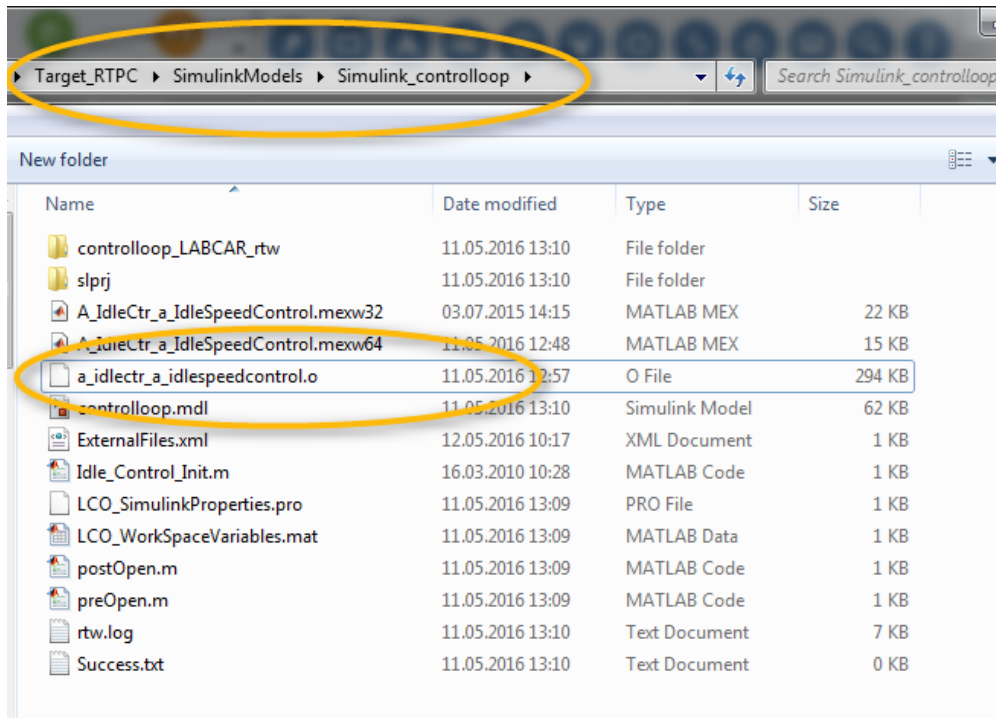

- There you leave all the .o-Files and delete the .c-Files of the corresponding S-Functions
- Switch into the LCO-Interface and go to Project\Options\Modules
- Highlight your Simulink®-model and click on "Link to External Files"

8. In the second row of windows you should now see all your .o-Files on the left side

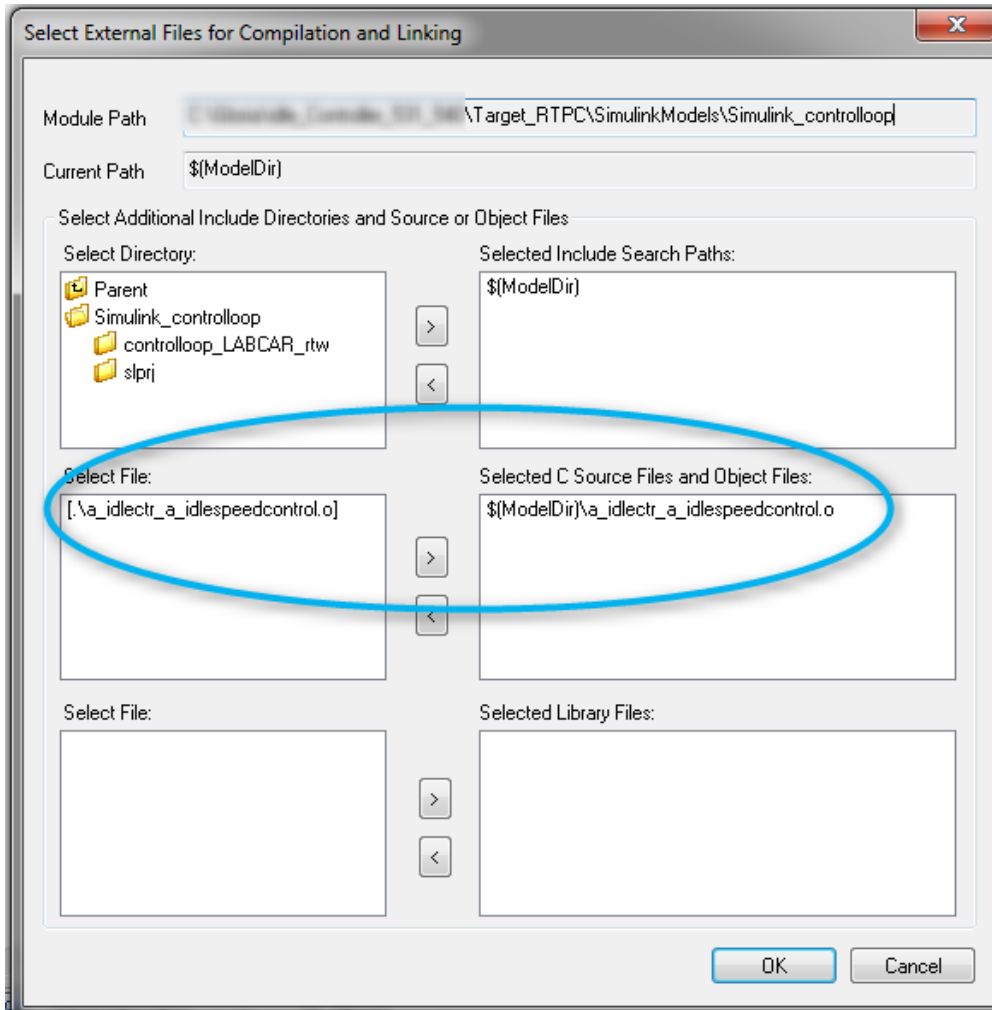

9. Move them all to the right, click "OK" and save the Project.
10. Now Building should be possible and the created Project has no more .c-Files which can be read by anybody.



Additional information:

Note

If you encounter a problem during Build, try to delete the original path of your Simulink®-model, which you used to include the model in your Project.



In case of further questions:

You will find further FAQ here: www.etas.com/en/faq

Please feel free to contact our Support Center, if you have further questions.

Here you can find all information: <http://www.etas.com/en/hotlines.php>

This information (here referred to as „FAQ“) is provided without any (express or implied) warranty, guarantee or commitment regarding completeness or accuracy. Except in cases of willful damage, ETAS shall not be liable for losses and damages which may occur or result from the use of this information (including indirect, special or consequential damages).